



**BRAVEHEART  
MARINE**

---

---



# LIBERTAS

## *Specifications*

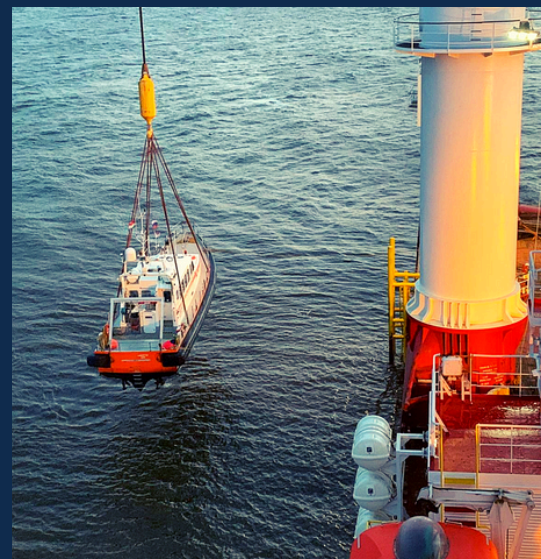





# SURVEY & CREW TENDER VESSEL

## LIBERTAS

### MAIN FEATURES

Length	17.50 meters
Breadth o.a.	5.00 meters
Draft	1.30 meter
Gross tonnage	38 tons
Flag state	The Netherlands
Year of build	2006
Call Sign	PCVF



MMSI	244663000
Max Speed	20 knots
Engines	2 x MAN D2676
Power output	2 x 650 HP
Fuel capacity	4.000 liters
Fresh water capacity	1.000 liters
Grey water capacity	500 liters

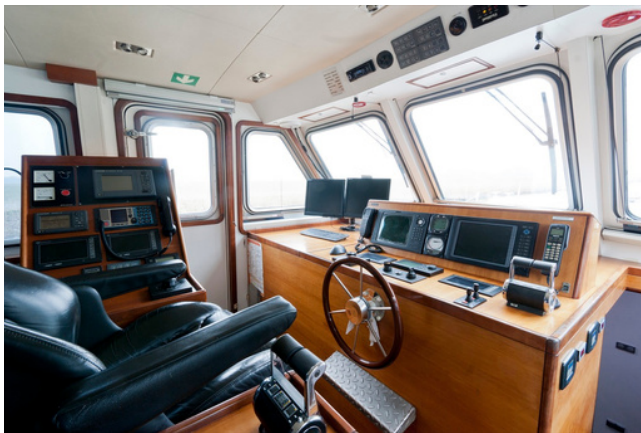

# GENERAL ARRANGEMENT

EQUIPPED FOR BOTH  
SURVEY AND CREW TENDER  
OPERATIONS.

- CTV up to 6 pax
- 1 toilet, galley & shower
- 2 cabins with 2 berths total
- Survey equipment hull mounted
- Survey desk
- Side pole available
- A-Frame
- Trading Area: 30 miles

## SURVEY EQUIPMENT

Kongsberg EM2040C

Dual head, dual swath

Singlebeam Reson 33/200 kHz

Hydrins iXBlue motion sensor

Valeport SVP & mini SVS

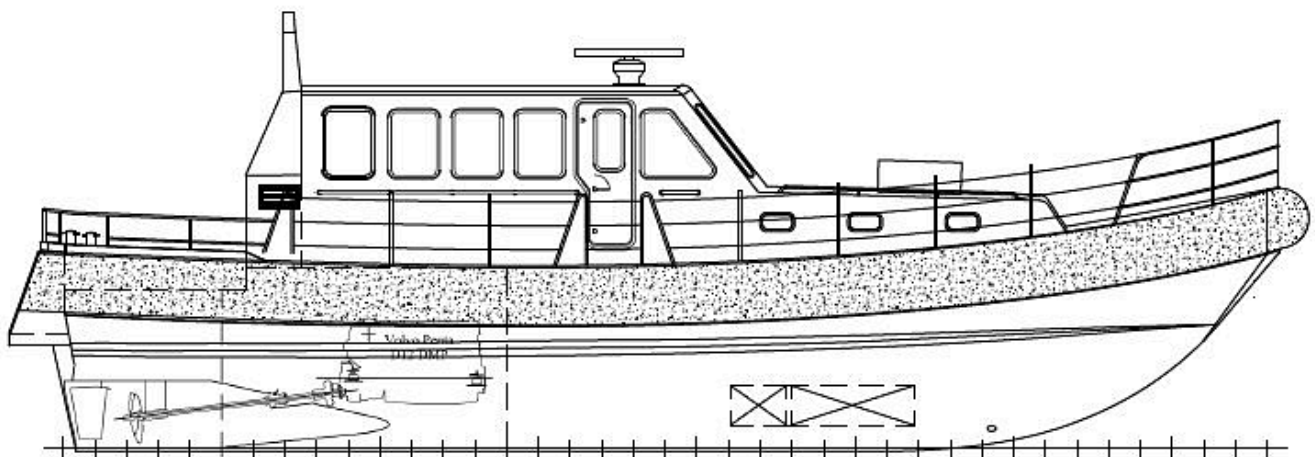
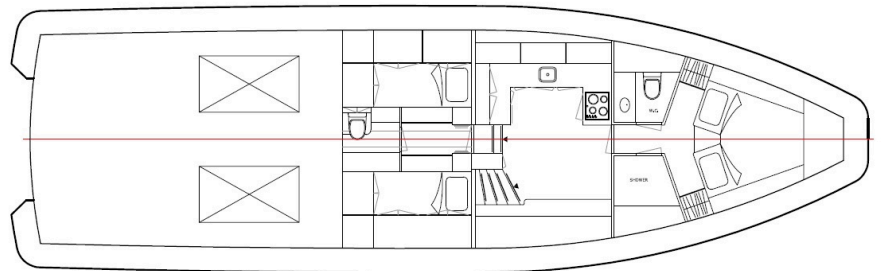
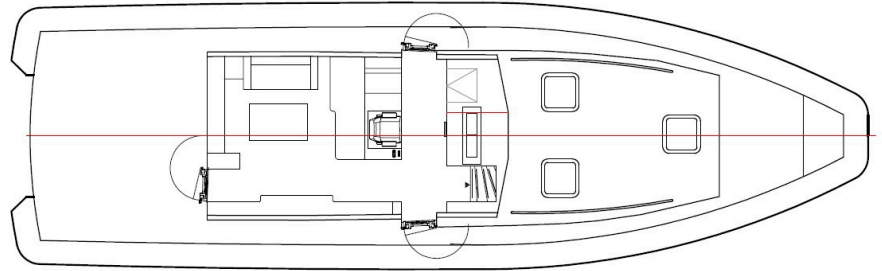

ENQUIRE TODAY!

[info@braveheartmarine.com](mailto:info@braveheartmarine.com)